

67 ± Acres

Jackson Twp. Allen County



Total Acres: Apx 67
Tillable Acres: Apx 38
Wooded Acres: Apx 7.5

Soil Types: Blount, Pewamo, Sloan & Glynwood

Annual Taxes: TBD

Parcel Number: 38130004001002 & Part of 38130004001000

1,200 head sow unit & 4,000 head nursery unit total apx 67 acres with apx 7.5 acres of woods, apx 38 acres tillable, 3.76 acres in CRP, 2 lagoons and balance in buildings & road right of way, property to be surveyed and taxes to be determined.

Chad Wright

419-236-7143
chadwright95@hotmail.com



Devin Dye

419-303-5891
devindye@gmail.com

Dye Real Estate & Land Company
3021 Harding Hwy. Suite E
Lima, OH 45804
www.dyerealestate.com



67 ± Acres

Jackson Twp. Allen County

Aerial Map



Fields | Ownership September 17, 2020

1 field, 61 acres in Allen County, OH

TOWNSHIP/SECTION 3S 8E - 13, 24, 3S 9E - 18, 19

Allen County, OH

FIELD	ACRES	LOCATION	OWNER (LAST UPDATED)	OWNER ADDRESS
	60.57	3S 8E - 13, 24, 3S 9E - 18, 19 APN: 38130004001000	ERNEST, BETHANY B (03/10/2020)	2985 N HARDIN RD, ADA, OH 45810



67 ± Acres

Jackson Twp. Allen County

Soil Map



Fields | Soil Survey September 17, 2020

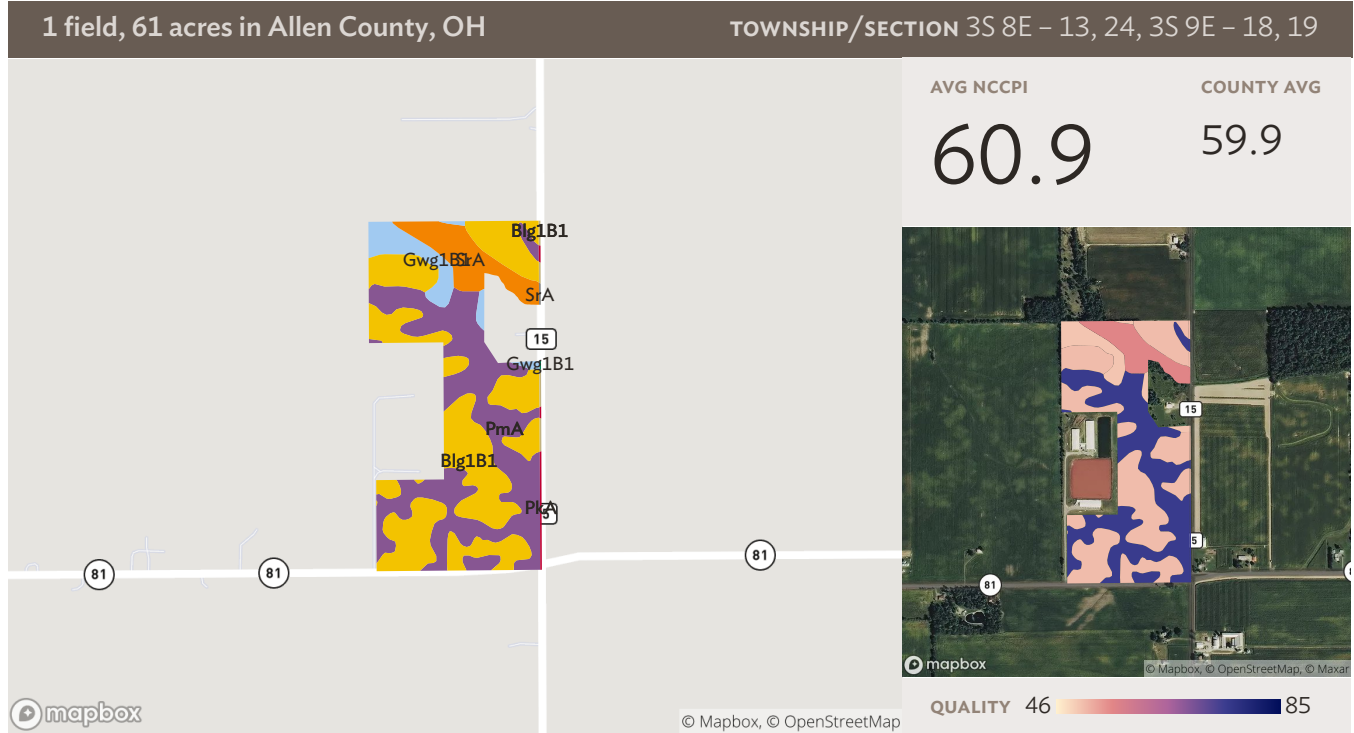

Source: NRCS Soil Survey

All fields

61 ac

SOIL CODE	SOIL DESCRIPTION	ACRES	PERCENTAGE OF FIELD	SOIL CLASS	NCCPI
Blg1B1	Blount silt loam, ground moraine, 2 to 4 percent slopes	26.83	44.3%	2	50.8
PmA	Pewamo silty clay loam, 0 to 1 percent slopes	23.41	38.6%	2	75.6
SrA	Sloan silty clay loam, till substratum, 0 to 1 percent slopes, frequently flooded	5.61	9.3%	3	56.0
Gwg1B1	Glynwood silt loam, ground moraine, 2 to 6 percent slopes	4.07	6.7%	2	50.0
PkA	Pewamo silty clay loam, 0 to 1 percent slopes	0.32	0.5%	2	75.6
Blg1B1	Blount silt loam, ground moraine, 2 to 4 percent slopes	0.26	0.4%	2	50.8
SrA	Sloan silty clay loam, till substratum, 0 to 1 percent slopes, frequently flooded	0.05	0.1%	3	56.0
Gwg1B1	Glynwood silt loam, ground moraine, 2 to 6 percent slopes	0.02	0.0%	2	50.0



67 ± Acres

Jackson Twp. Allen County

Plat Map

