

**HOWBERT SURVEYING LLC**  
 8477 MERICLE ROAD  
 FORT JENNINGS, OHIO 45844  
 419-863-0289

DATE: 10/18/23  
 CLIENT: LIBERTYOAKS  
 JOB #: 898-10-23

REV.:  
 SCALE: 1" = 300'  
 CHK:

THIS PLAT IS BASED ON AN ACTUAL FIELD SURVEY.

*Michael L. Howbert*  
**MICHAEL L. HOWBERT**  
 REGISTERED PROFESSIONAL SURVEYOR NO. 7959 IN OHIO  
 OCTOBER 18, 2023

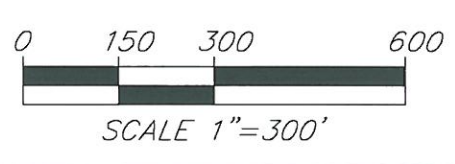
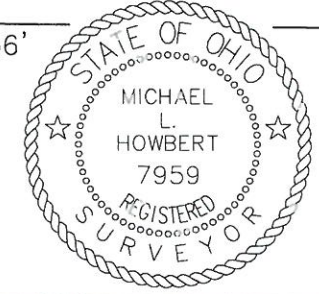

# PLAT OF SURVEY FOR LIBERTY OAKS

SITUATED IN:  
THE NW. 1/4 AND SW. 1/4, SECTION 13  
TOWN 2 N. RANGE 5 E.,  
MONROE TOWNSHIP,  
PUTNAM COUNTY, OHIO

KNOW ALL MEN BY THESE PRESENT:  
THAT I THE UNDERSIGNED OWNER OF THE  
LANDS INDICATED ON THIS PLAT DO HEREBY  
APPROVE OF THE PLAT OF SUBDIVISION AND  
RESERVE THE INGRESS/EGRESS EASEMENTS  
AS SHOWN HEREON AND DESIRE THE SAME  
TO BE PLACED ON PUBLIC RECORD.

STATE OF \_\_\_\_\_  
SS:  
COUNTY OF \_\_\_\_\_  
BEFORE ME, A NOTARY PUBLIC IN AND FOR  
SAID COUNTY, PERSONALLY APPEARED:

THE OWNER OF THE LANDS SHOWN HEREON  
AND HEREBY AFFIRM THAT SIGNING OF THE  
ABOVE DEDICATION AS THEIR FREE ACT, AND  
DEED. AS WITNESS WHEREOF I HEREUNTO  
SUBSCRIBE MY NAME AND AFFIX MY OFFICIAL  
SEAL

THIS \_\_\_\_\_ DAY OF \_\_\_\_\_,

NOTARY PUBLIC: \_\_\_\_\_

MY COMMISSION EXPIRES: \_\_\_\_\_

## DESCRIPTION 32.397 ACRES

Situated in the Southwest Quarter of Section 13,  
Town 2 North, Range 5 East, Township, Putnam  
County, Ohio, being part of the southwest quarter  
as described in Official Record Volume 659, Page  
1196-1202 and being more particularly described as  
follows;

Beginning at the northwest corner of the southwest  
quarter of said Section 13, being a 5/8" iron pin  
set;

Thence along the north line of said southwest  
quarter, S.88°57'02"E., a distance of 1118.50 feet  
to a 5/8" iron pin set;

Thence running along a new division line on the  
following four (4) courses and distances:

1. S.11°08'30"W., a distance of 738.91 feet to a  
5/8" iron pin set;
2. S.05°18'31"W., a distance of 613.40 feet to a  
5/8" iron pin set;
3. S.80°21'40"E., a distance of 133.59 feet to a  
5/8" iron pin set;
4. S.19°31'11"W., a distance of 161.77 feet to a  
mag nail set in the centerline of State Route 15,  
passing a 5/8" iron pin set at 131.77 feet;

Thence along said centerline on the following two  
(2) courses and distances:

1. N.76°04'06"W., a distance of 376.01 feet to a  
mag nail set;
2. N.76°05'29"W., a distance of 662.16 feet to a  
mag nail set in the west line of said southwest  
quarter;

Thence on said west line, N.00°30'13"E., a  
distance of 1281.43 feet to the Point of Beginning;

Containing 32.397 acres, more or less and being  
subject to all legal highways, rights-of-way,  
easements, restrictions, covenants, and/or conditions  
of record.

The above description and bearing system is based  
on a survey prepared by Michael L. Howbert,  
Registered Professional Surveyor No. 7959, in August  
of 2023.

## DESCRIPTION 49.592 ACRES

Situated in the Southwest Quarter of Section 13,  
Town 2 North, Range 5 East, Township, Putnam  
County, Ohio, being part of the southwest quarter  
as described in Official Record Volume 659, Page  
1196-1202 and being more particularly described as  
follows;

Commencing at the northwest corner of the  
southwest quarter of said Section 13, being a 5/8"  
iron pin set;

Thence along the north line of said southwest  
quarter, S.88°57'02"E., a distance of 1118.50 feet  
to a 5/8" iron pin set, being the Principal Point of  
Beginning;

Thence continuing along said north line,  
S.88°57'02"E., a distance of 1544.80 feet to a 1/2"  
iron pin found at the northeast corner of said  
southwest quarter;

Thence on the east line of said southwest quarter,  
S.00°40'11"W., a distance of 469.90 feet to a 5/8"  
iron pin set at the intersection of said east line  
with the north line of the former Toledo St. Louis  
and Western Railroad;

Thence running along said north line on the  
following three (3) courses and distances:

1. S.37°22'03"W., a distance of 1104.43 feet to a  
point witness a 5/8" iron pin found 0.81 feet north;
2. N.00°40'11"E., a distance of 40.17 feet to a  
point witness a 5/8" iron pin found 0.90 feet north;
3. S.37°22'03"W., a distance of 445.04 feet to a  
mag nail set in the centerline of State Route 15,  
passing a 5/8" iron pin set at 422.39 feet;

Thence along said centerline, N.76°04'06"W., a  
distance of 742.85 feet to a mag nail set;

Thence running along a new division line on the  
following four (4) courses and distances:

1. N.19°31'11"E., a distance of 161.77 feet to a  
5/8" iron pin set, passing a 5/8" iron pin set at  
30.00 feet;
2. N.80°21'40"W., a distance of 133.59 feet to a  
5/8" iron pin set;
3. N.05°18'31"E., a distance of 613.40 feet to a  
5/8" iron pin set;
4. N.11°08'30"E., a distance of 738.91 feet to the  
Point of Beginning;

Containing 49.592 acres, more or less and being  
subject to all legal highways, rights-of-way,  
easements, restrictions, covenants, and/or conditions  
of record.

The above description and bearing system is based  
on a survey prepared by Michael L. Howbert,  
Registered Professional Surveyor No. 7959, in August  
of 2023.

## DESCRIPTION

Situated in the Northwest Quarter of Section 13,  
Town 2 North, Range 5 East, Township, Putnam  
County, Ohio, being part of the southwest quarter  
as described in Official Record Volume 659, Page  
1196-1202 and being more particularly described as  
follows;

Beginning at the southwest corner of the northwest  
quarter of said Section 13, being a 5/8" iron pin  
set;

Thence along the west line of said northwest  
quarter, N.00°46'06"E., a distance of 1326.78 feet  
to a 5/8" iron pin set;

Thence along the north line of the south half of  
said northwest quarter, S.89°05'52"E., a distance of  
1995.19 feet to a 5/8" iron pin set at the northeast  
corner of the west half of the southeast quarter of  
said northwest quarter;

Thence on the east line of said west half of the  
southeast quarter of said northwest quarter,  
S.00°40'15"W., a distance of 1331.92 feet to a 5/8"  
iron pin set at the southeast corner of the west  
half of the southeast quarter of said northwest  
quarter;

Thence along the south line of the south half of  
said northwest quarter, N.88°57'02"W., a distance of  
1997.48 feet to the Point of Beginning;

Containing 60.923 acres, more or less and being  
subject to all legal highways, rights-of-way,  
easements, restrictions, covenants, and/or conditions  
of record.

The above description and bearing system is based  
on a survey prepared by Michael L. Howbert,  
Registered Professional Surveyor No. 7959, in August  
of 2023.

I HEREBY CERTIFY THAT THIS PLAT OF THE LANDS SHOWN  
HEREON AND DESCRIBED HEREON WAS PRESENTED TO ME  
AND ENTERED FOR TRANSFER THIS \_\_\_\_\_ DAY OF \_\_\_\_\_,

BY: \_\_\_\_\_  
PUTNAM COUNTY AUDITOR

APPROVED BY THE PUTNAM COUNTY ENGINEERS  
OFFICE THIS \_\_\_\_\_

DAY OF \_\_\_\_\_, \_\_\_\_\_  
ORC.: 315.251

BY: \_\_\_\_\_

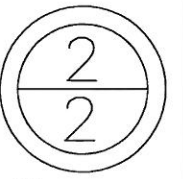

<b>HOWBERT SURVEYING LLC</b>	
8477 MERICLE ROAD FORT JENNINGS, OHIO 45844 419-863-0289	
DATE: 10/18/23	REV.:
CLIENT: LIBERTY OAKS	SCALE: N/A
JOB #: 898-10-23	CHK: